

## ONYX® 11.75" High Temperature, Standard Magnetics

### US Specifications

#### Construction

Anode	304 Stainless Steel
Cathode Body	OFHC Copper
Insulator	Ceramic

#### Cooling Requirements

Flow Rate at Maximum Power	Consult Factory
Maximum Input Pressure, Open Drain	60 psi
Maximum Input Temperature	68 °F

#### Dimensions

A	Consult Factory
B	Consult Factory
C	Consult Factory

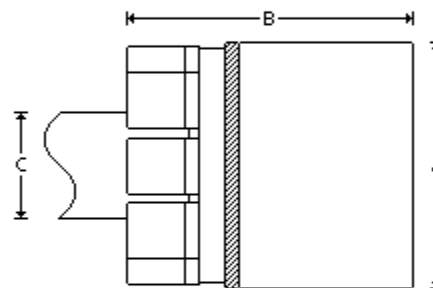

#### General

Magnetic Enhancement	Permanent (NdFeB) Encapsulated
Maximum Temperature	392 °F
Source to Substrate Distance	2.000" - 12.000"
Weight, Approximate Without Options	Consult Factory

#### Maximum Sputtering Power \*

Cathode Voltage	Consult Factory
Discharge Current	Consult Factory
Indirect Cooled Mode, DC	Consult Factory
Indirect Cooled Mode, RF	Consult Factory
Operating Pressure	Consult Factory

---

**Mounting, Standard**

Power Cable, DC	Consult Factory
Power Cable, RF	Consult Factory
Power Connector, DC	Consult Factory
Power Connector, RF	Consult Factory
Stem, Outer Dimension Tubing	Consult Factory
Water, Outer Dimension Tubing	Consult Factory

---

**Target**

Cooling	Consult Factory
Diameter	Consult Factory
Form	Circular / Planar
Thickness	Consult Factory

---

**Specifications Disclaimer**

- All Angstrom Sciences NdFeB magnets are totally encapsulated and protected from degradation by water.
- All sources are available in external configurations.
- \* Maximum power for cathode only, a target material's properties, such as, thermal and electrical conductivity may limit the maximum process power level.
- Some custom-engineered and specialty magnetrons may not meet standard specifications.
- Specifications are subject to change without notice.
- Typical performance. Results may vary with process parameters such as pressure, flow rate, target material, and substrate rotation, etc.

---

Please contact us for specifications regarding your application.

Angstrom Sciences | Call +1-412-469-8466 | [www.angstromsciences.com](http://www.angstromsciences.com)